

MANCHESTER/Barton
EGCB

<p>GUND (Geoid Undulation) =</p> <p>The height of the Geoid (MSL) above the Reference Ellipsoid (WGS 84) at the stated position.</p> <p>BEARINGS ARE MAGNETIC</p> <p>ELEVATIONS AND HEIGHTS ARE IN FEET</p>	<p>123</p> <p>(50)</p>
--	-------------------------------

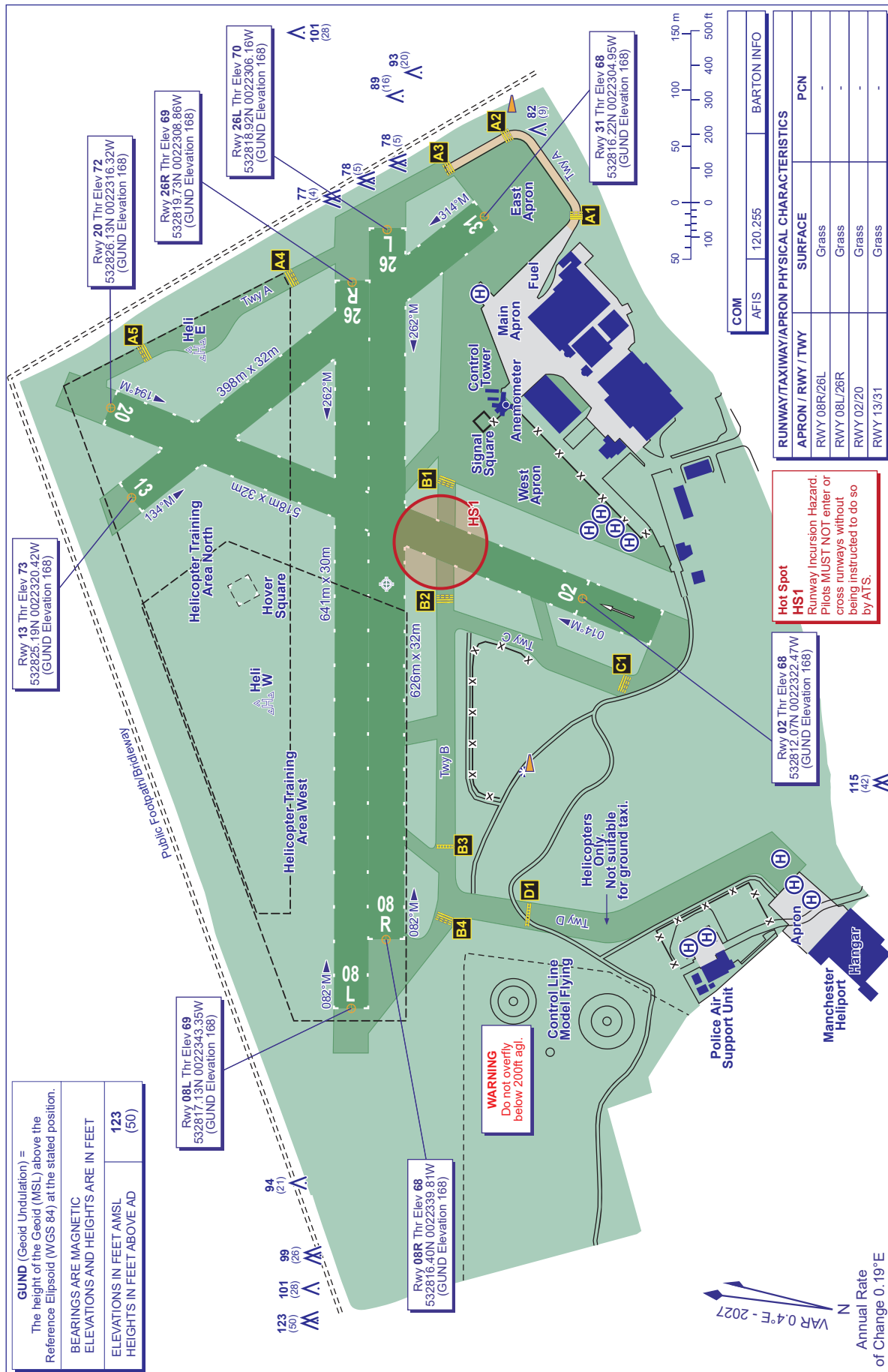

COMI		BARTON INFO	
AFIS	120.255		
RUNWAY/TAXIWAY/APRON PHYSICAL CHARACTERISTICS			
APRON / RWY / TWY	SURFACE		PCN
RWY 08R/26L	Grass		-
RWY 08L/26R	Grass		-
RWY 02/20	Grass		-
RWY 13/31	Grass		

**Hot Spot
HS1**
Runway Incursion Hazard.
Pilots MUST NOT enter or
cross runways without
being instructed to do so
by ATIS

115
(42) 

Annual Rate
of Change 0.19°E

CHANGE (4/26): OBSTACLES.